



# MEMORANDUM

---

**TO:** Mayor and City Councilors

**FROM:** Rich Olson, City Manager  
Larry M. Mackey, Fire Chief

**DATE:** July 6, 2015

**REF:** Consideration – Authorization for Live Fire Training

***BACKGROUND:***

The City has received a request from Dr. Andrea Williams, on behalf of the Williams family, for the Elizabeth City Fire Department to utilize for Live Fire Training the structure located at 1308 Southern Avenue. The structure is owned by Dr. Williams' mother, Rubenia S. Williams. This structure meets the criteria for the Elizabeth City Fire Department's Live Fire Guidelines. A copy of the tax record for this property is attached for your reference.

***ANALYSIS:***

This structure provides an opportunity for live fire training for the department's newer personnel. The live fire evolution will be executed at a time that will minimize traffic concerns as well as accomplish multi-company drills. The projected date is August 5, 2015, as weather conditions permit. While we typically do not burn structures during the summer months, we have several new personnel that must have this training in order to receive their NC Firefighter Certification. City Ordinance Section 34 – 29, Criteria for Live Burn Training will be adhered to.

***STAFF RECOMMENDATION:***

By motion, authorize the Elizabeth City Fire Department to use the structure located at 1308 Southern Avenue for live fire training.

RCO/vdw

**PASQUOTANK COUNTY RESIDENTIAL PROPERTY INFORMATION**

<b>Tax Info</b>	<a href="#">Maps</a>	<a href="#">Sales</a>	<a href="#">Election Info</a>	<a href="#">Other</a>
<b>Location: 01308</b>	<b>Acct: 36325</b>	<b>PIN: 892313044857</b>	<b>MAP: 56-B-8</b>	<b>Deed: 484/266</b>
<b>SOUTHERN AVE</b>				<b>Deed Date: 0</b>

\$ \$

Owner

**WILLIAMS, RUBENIA S**  
**1305 HALSTEAD BLVD**  
**ELIZABETH CITY, NC**  
**27909**

Assessment

<b>Prior Land:</b>	<b>\$8,000.00</b>	<b>Current Land:</b>	<b>\$7,800.00</b>
<b>Prior Bldg:</b>	<b>\$32,100.00</b>	<b>Current Bldg:</b>	<b>\$9,600.00</b>
<b>Prior Total:</b>	<b>\$40,100.00</b>	<b>Current Total:</b>	<b>\$17,400.00</b>

**Taxed Acres: 0.092**

**\*Estimated\* 2013 City Tax: \$ 198.50 :**  
**\*Estimated\* 2014 City Tax: \$107.01**  
**\*Estimated\* 2013 County Tax: \$252.63 :**  
**\*Estimated\* 2014 County Tax: \$132.24**



ELIZABETH CITY INSID

[Click here to send Pasquotank County a better/correct picture. PID: 0013366](#)

Last Update: 20130626

DATE	SALES TYPE	SALE PRICE	SOURCE	ASSESSMENT	DI
No sales data.					
LAND TYPE	SIZE	MKT Value			
PRIMARY	4000.0 SQ FT	\$ 7,750.00			

**DWELLING DATA (SEE DISCLAIMER)**

STYLE	OLD STYLE
STORY HEIGHT	1.5
ATTIC	NONE
BEDROOMS	2
TOTAL ROOMS	5

**COST DATA**

BASE PRICE	\$ 57,470.00
PLUMBING ADJ	\$ 0.00
HEATING/AC ADJ	\$ 0.00
EXTERIOR TRIM	\$ 0.00
FINISHED BASEMENT ADJ	\$ 2

FULL BATHS	1	FIREPLACES	\$ 0.00
HALF BATHS	0	ADDITIONS	\$ 19,300.00
YEAR BUILT	1925	SUBTOTAL	\$ 79,950.00
YEAR REMODELED	0	GRADE FACTOR	0.7
GROUND FLOOR AREA	672.0	REPLACEMENT COST	\$ 55,970.00
TOTAL LIVING AREA	1208	PERCENT GOOD	17%
CONDITION	PR	RCNLD	\$ 9,500.00

*DISCLAIMER: DWELLING DATA BASED ON OBSERVATION AND MAY NOT REFLECT ACTUAL VALUES. DWELLING DATA DOES NOT AFFECT THE VALUATION OF PROPERTY.*

**OUTBUILDING DATA**

Type	Qty	Year	Size	Grade	Cond	Mode Code	MKT Adj	RCN	%GD	Value
RS1	1	1925	8X14.0	D	F	0 0 0 0	0	1229.505	10.0	\$ 120.0

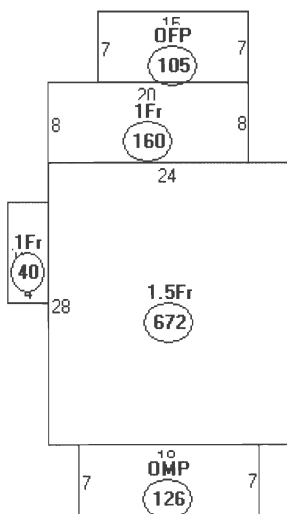

Descriptor/Area

- A: 1.5Fr  
672 sqft
- B: 1Fr  
105 sqft
- C: 1Fr  
160 sqft
- D: 1Fr  
126 sqft
- E: 1Fr  
40 sqft